

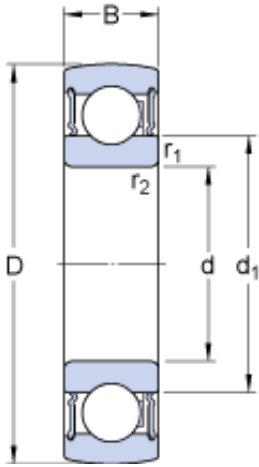

France Import Bearing Co., Ltd.



50 mm x 110 mm x 27 mm SKF 1726310-2RS1 deep groove ball bearings

Bearing No. 1726310-2RS1

1726310-2RS1 Bearing 2D drawings and 3D CAD models

Size	110x50x27 mm
Bore Diameter	110 mm
Outer Diameter	50 mm
Width	27 mm
d	50 mm
D	110 mm
B	27 mm
d ₁	68.76 mm
r _{1,2} - min.	2 mm
Basic dynamic load rating - C	61.8 kN
Basic static load rating - C ₀	38 kN
Fatigue load limit - P _u	1.6 kN
Limiting speed	4300 r/min
Calculation factor - f ₀	13
Category	Insert Bearings Spherical OD
Inventory	0.0
Manufacturer Name	SKF
Minimum Buy Quantity	N/A
Weight / Kilogram	1.074
EAN	7316577043047
Product Group	B00308
Inner Race Profile	Standard Inner Ring
Outer Race Profile	Spherical



France Import Bearing Co., Ltd.

Relubricatable	No
Seal Type	RS1 Seal
Mounting Method	Shaft Mount
Rolling Element	Ball Bearing
Snap Ring	No
Long Description	50MM Bore; Standard Inner Ring; Ball Bearing; 27MM Length Thru Bore; 27MM Outer Race Width; 110MM Outside Diameter; Not Relubricatable; RS1 Seal Seal; Shaft Mount Mounting Method; No Snap Ring
Inch - Metric	Metric
Other Features	Single Row Standard Duty Metric
Category	Insert Bearings
UNSPSC	31171536
Harmonized Tariff Code	8482.10.50.00
Noun	Bearing
Keyword String	Insert
Manufacturer URL	http://www.skf.com
Manufacturer Item Number	1726310-2RS1
Weight / LBS	2.09
Outside Diameter	4.331 Inch 110 Millimeter
Length Thru Bore	1.063 Inch 27 Millimeter
Outer Race Width	1.063 Inch 27 Millimeter
Bore	1.969 Inch 50 Millimeter
bore diameter:	50 mm
radial static load capacity:	38 kN
outside diameter:	110 mm
finish/coating:	Uncoated
outer ring width:	68.7 mm
maximum rpm:	4300 RPM
bore type:	Round



France Import Bearing Co., Ltd.

seal type:	Contact/Lip
operating temperature range:	-40 to +210 ° F
series:	17263
radial dynamic load capacity:	38 kN
d_1	68.76 mm
$r_{1,2}$ min.	2 mm
Basic dynamic load rating C	61.8 kN
Basic static load rating C_0	38 kN
Fatigue load limit P_u	1.6 kN
Limiting speed ¹⁾	4300 r/min
Calculation factor f_0	13
Mass complete bearing	1.05 kg