

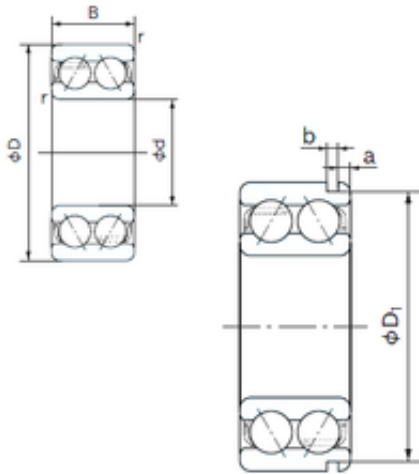

# France Import Bearing Co., Ltd.



## 60 mm x 110 mm x 36.5 mm NACHI 5212AN angular contact ball bearings

Bearing No. 5212AN

5212AN Bearing 2D drawings and 3D CAD models

Size	60x110x36.5 mm
Bore Diameter	60 mm
Outer Diameter	110 mm
Width	36.5 mm
d	60 mm
D	110 mm
B	36.5 mm
C	36.5 mm
a	3.28 mm
b	2.7 mm
r min.	1.5 mm
D1	106.81 mm
Weight	1.36 Kg
Basic dynamic load rating (C)	71,5 kN
Basic static load rating (C0)	58,5 kN
(Grease) Lubrication Speed	3800 r/min
Bore Type	Cylindrical Bore
Enclosure	Open
Configuration	Double Row
Bore Size	60 mm
Outside Diameter	110 mm
Width	36.5 mm
Fillet Radius/Chamfer	1.5 mm
Groove Width	2.7 mm
Groove Diameter	106.8 mm



## France Import Bearing Co., Ltd.

a (max)	3.3 mm
Dynamic Load Rating	71,500 N
Static Load Rating	58,500 N
Limiting Speed - Grease	3,800 rpm
Limiting Speed - Oil	5,000 rpm
Radial Clearance	0.008 to 0.028 mm
da	69 mm
Da	101 mm
Dx	118 mm
ra	1.5 mm
Cy	5.4 mm